



RECTANGULAR HEAD FIBER

New FT-Z8 SERIES

Smallest in the industry!

Easy, space-saving screw type installation

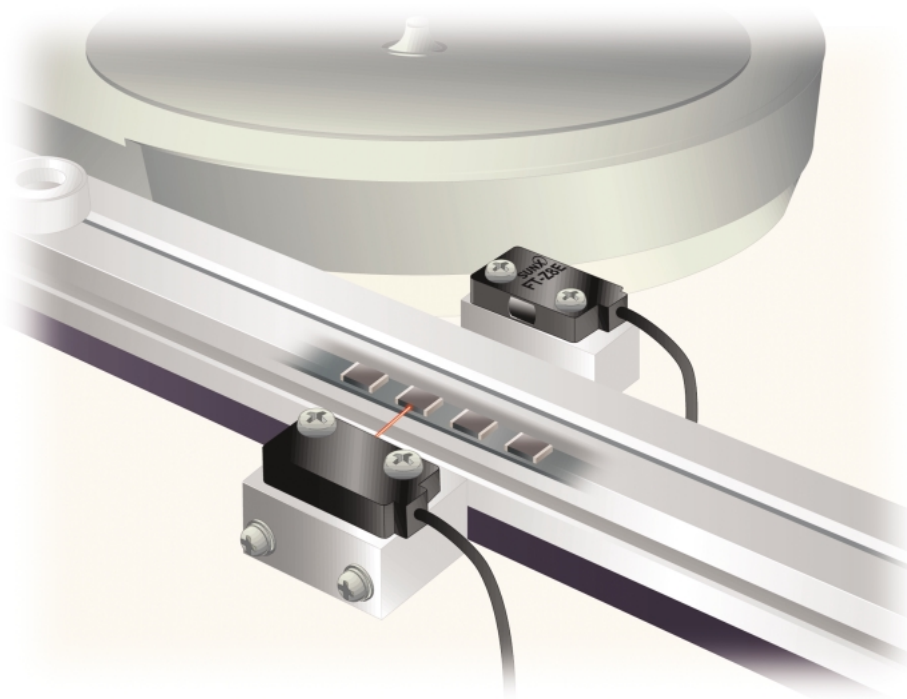

Rectangular Fiber Head Allows for Easy Installation

The fiber head has a square shape and can be installed by using M2 screws at two points. Installation and beam axis alignment can be easily performed.

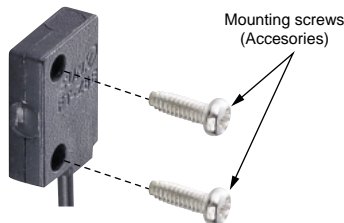

Extremely Thin, the Smallest Size in the Industry

The smallest super thin type rectangular head fiber in the industry with dimensions of W3 × H12 × D8mm (side sensing type).

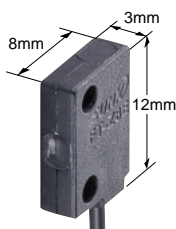

Utilizes Flexible Inflection Resistant Cable

Allowable bending radius of R4mm. The fiber can withstand repeated bending of one million cycles or more at R10mm. The fiber can be bent at small angles and are resistant to repeated bending, thus saving installation space and making these fibers the best for use in sensing applications on mobile elements.

Long Sensing Range 2,700mm

Top sensing type fiber realizes a long sensing range of 2,700mm (front sensing type: 800mm, side sensing type: 1,600mm).

Flexible Mounting

Three types, front sensing type, side sensing type and top sensing type fibers are available. Select depending on the place of mounting.

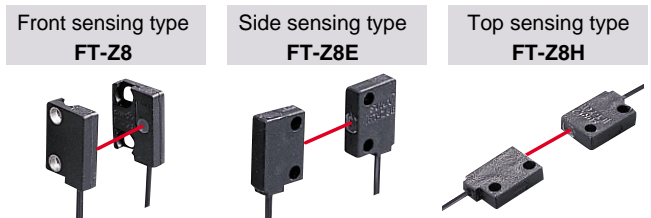

SPECIFICATIONS

Type	Front sensing	Side sensing	Top sensing	
Item	Model No.	FT-Z8	FT-Z8E	FT-Z8H
Applicable amplifier (Note 1)	FX-301			
Sensing range	LONG 800mm STD 400mm FAST 300mm	LONG 1,600mm STD 800mm FAST 600mm	LONG 2,700mm STD 1,400mm FAST 1,000mm	
Min. sensing object	ϕ 0.03mm opaque object (Note 2)			
Allowable bending radius	R4mm or more			
Bending durability	One million times or more (at R10mm)			
Fiber cable length	2m free-cut			
Ambient temperature	- 40 to + 60°C, Storage: - 40 to + 60°C (No dew condensation or icing allowed)			
Ambient humidity	35 to 85% RH, Storage: 35 to 85% RH			
Material	Fiber cable	Fiber core: Acrylic, Sheath: Vinyl chloride		
	Fiber head	Enclosure: Polycarbonate		
Weight	8g approx			
Accessories	Mounting screw: 1 set, FX-CT2 (Fiber cutter): 1 No. FX-AT5 (ϕ 1.3mm fiber attachment): 1 set			

Notes: 1) For further details, refer to **FX-301** catalog. Please contact our office about another applicable amplifiers.

2) This is the value for detection under the optimum sensitivity at the maximum sensing distance.

DIMENSIONS (Unit: mm)

FT-Z8

Free-cut With attachment

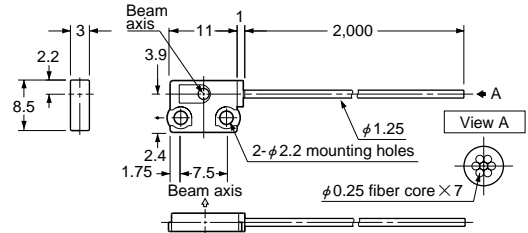

Note: Beam emitting fiber and beam receiving fiber are symmetrical.

FT-Z8E

Free-cut With attachment

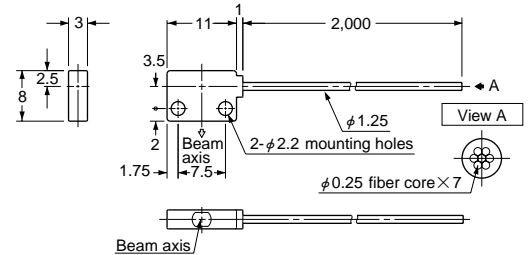

FT-Z8H

Free-cut With attachment

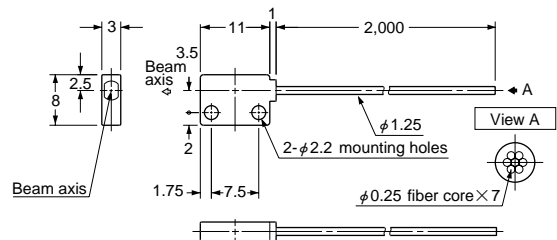

SENSING CHARACTERISTICS (TYPICAL)

Parallel deviation

FT-Z8

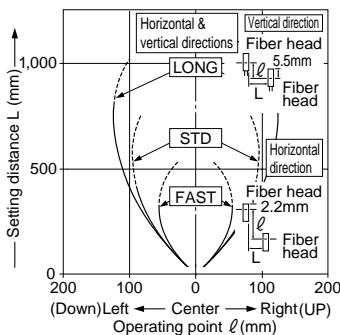

FT-Z8E

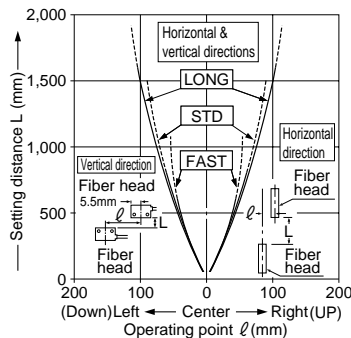

FT-Z8H

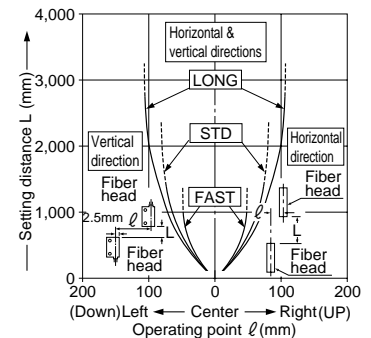

All information is subject to change without prior notice.